

OWNER'S MANUAL

Assembly & Operating Instructions

BBT 21" ELECTRIC START B&S SELF PROPELLED LAWN MOWER

MODEL NO. BBT-LM-SPBSES



N23701



To the Owner

Thank you for purchasing our BBT 21" Electric Start Self Propelled B&S Lawn Mower. It was carefully engineered to provide excellent performance when properly operated and maintained.

Please read this entire manual prior to operating the Lawn Mower. It instructs you how to safely and easily set up, operate and maintain your Lawn Mower. Please be sure that you and any other persons who will operate the Lawn Mower carefully follow the recommended safety practices at all times. Failure to do so could result in personal injury or property damage.

All information in this manual is relative to the most recent product information available at the time of printing. Review this manual frequently to familiarise yourself with the machine, its features and operation. Please be aware that this Owner's Manual may cover a range of product specifications for various models. Characteristics and features discussed and/or illustrated in this manual may not be applicable to all models. We reserve the right to change product specifications, designs and equipment without notice and without incurring obligation.

All the power testing information used to establish the power rating of the engine equipped on this Lawn Mower can be found in the engine manufacturer's manual or website. If you have any problems or questions concerning the machine, please contact our Customer Support Department.

Throughout this manual, all references to right and left side of the Lawn Mower are observed from the operating position. The engine manufacturer is responsible for all engine-related issues with regards to performance, power-rating, specifications, warranty and service. Please refer to the engine manufacturer's Owner's Manual packed separately with your Lawn Mower for more information.

Customer Support

Please do NOT return the Lawn Mower without first contacting the Customer Support Department at bbt@bbta.com.au.

If you have difficulty assembling this product or have any questions regarding the controls, operation, or maintenance of this Lawn Mower, please contact our Customer Support Department.

SAVE THESE INSTRUCTIONS

TABLE OF CONTENTS

	Page(s)
To the Owner	2
Customer Support.....	2
TABLE OF CONTENTS	3
IMPORTANT SAFETY INFORMATION	4-5
Additional Information and Potential Changes.....	4
Key to Symbols.....	5
GENERAL SAFETY RULES	6-7
General Safety Rules.....	6
Specific Safety Rules	6
Spark Plug Safety Rules	7
Fire and Burn Hazards	7
PARTS LOCATION.....	8
ASSEMBLING	8-11
Grass Catcher.....	8
Handle	9
Armrest Panel.....	9
Assembly and Remove the battery	9
Starting Electric Start Engine	10
Cutting Height Adjustments.....	10
Safety Precautions	11
OPERATIONS	12-13
Engine Starting	12
Gear Box	12
3 in 1 Function (Mulching, Side-discharge, Rear-discharge)	13
MAINTENANCE CARE	14
Maintenance and Storage.....	14
Blade.....	14
SPECIFICATIONS.....	15
WARRANTY & SERVICE	15
EXPLODED DIAGRAM & PARTS LIST.....	16-17
YOU MAY ALSO LIKE	18



IMPORTANT SAFETY INFORMATION



WARNING: Read and thoroughly understand all instructions in this manual and on the safety decals before assembling or operating this Lawn Mower. Failure to do so may cause serious injury or death. Do not allow anyone to operate this Lawn Mower who has not read this manual. As with all power equipment, a Lawn Mower can be dangerous if assembled or used improperly. Do not operate this Lawn Mower if you have any questions concerning its safe operation. To get answers to any questions, call our Customer Support Department.



This **SAFETY ALERT SYMBOL** identifies important safety messages in this manual. Failure to follow this important safety information may result in serious injury or death.



DANGER! This Lawn Mower was built to be operated according to the safe operation practices in this manual. As with any type of power equipment, carelessness or error on the part of the operator can result in serious injury. This Lawn Mower is capable of amputating hands and feet and throwing debris. Failure to observe the following safety instructions could result in serious injury or death.

The following signals, words and meanings are intended to explain the levels of risk associated with this product.



DANGER

DANGER indicates a hazardous situation which, if not avoided, will result in serious injury or death.



WARNING

WARNING indicates a hazardous situation which, if not avoided, could result in serious injury or death.



CAUTION

CAUTION indicates a hazardous situation which, if not avoided, could result in minor or moderate injury.

NOTICE

NOTICE is important information about the proper use of your Lawn Mower. Failure to follow this instruction could result in damage to your Lawn Mower or property.

Additional Information and Potential Changes

We reserve the right to discontinue, change, and improve our products at any time without notice or obligation to the purchaser. The descriptions and sections contained in this manual were in effect at the time of printing. Equipment described within this manual may be optional. Some illustrations may not be applicable to your machine.

WARNING! Your Responsibility—Restrict the use of this power machine to persons who have read, understood and will follow the warnings and instructions in this manual and on the machine.

SAVE THESE INSTRUCTIONS!



IMPORTANT SAFETY INFORMATION

Key to Symbols

Symbol	Description
	READ THE OWNER'S MANUAL(S) Read, understand and follow all instructions in the manual(s) before attempting to assemble and operate.
	FACE PROTECTION Always wear safety goggles or safety glasses with side shields or a face shield when operating this product as well as ear protection.
	WEAR GLOVES Always wear non-slip, heavy-duty protective gloves when operating this product.
	WEAR SAFETY FOOTWEAR Always wear non-slip steel-toed safety footwear when operating this product.
	BEWARE OF FLYING OBJECTS Beware of thrown objects which can ricochet causing serious injury to the eyes. Always wear eye & ear protection when operating.
	BYSTANDERS Keep bystanders, helpers, pets, and children at least 25 metres from the machine while it is in operation. Stop machine if anyone enters the area.
	TOXIC FUMES Breathing exhaust fumes can cause loss of consciousness and may lead to death. DO NOT operate the machine in an enclosed space.
	PETROL IS FLAMMABLE Petrol is extremely flammable. Allow the engine to cool for at least ten minutes before refuelling.
	DANGER! Keep your hands and feet away from the cutting element!
	Remove the spark plug before carrying out repairs.
	CAUTION! Tool surfaces can be hot.
	DO NOT use in the rain.
	Blades continue to rotate after the engine stops. Rotating blades are capable of amputating hands and feet and throwing objects.

GENERAL SAFETY RULES

- These models of petrol lawn mowers are intended for grass mowing, other uses are not permitted.
- It is only suitable for private use in home and hobby gardens. Mowers for private home and hobby garden use are considered to be those used for the care of private grass areas and lawns, but not for use in public areas, parks, sports areas, and in agriculture and forestry.
- Read, understand, and follow all instructions on the machine and manual before attempting to assemble and operate. Keep this manual in a safe place for future and regular reference. Anyone who uses this Lawn Mower must read the instructions and be familiar with the mower.
- Please, read and take note of the following comments that regard your protection against the risk of injury and fire.

General Safety Rules

- This machine is to be used exclusively for cutting natural grass. **NEVER** use the mower for any other purposes. Any other utilization can involve danger to your safety and can involve damage to the mower.
- People under 16 years and people who are not familiar with the Owner's Manual must not use the mower.
- The user is responsible of the safety of other people in the working area. Keep children and animals at a safe distance while the mower is in use.
- Before mowing, remove all foreign objects from the lawn which may be thrown by the machine, stay alert for any foreign object which may have been missed.
- Check that all nuts, bolts and screws are well tightened.
- Before mowing, place the grass catcher in its position.
- Before mowing, make sure that the blade and the blade fixing screw are securely fastened. When cutting edges, blades may require re sharpening, this must be done evenly on both sides, in order to prevent any imbalance. If the blade is damaged, it must be replaced.
- When mowing, always wear long trousers and protective footwear.
- **NEVER** run the engine in an enclosed and/or poorly ventilated area, engine exhaust contains carbon monoxide, a colourless and odourless gas. Breathing exhaust fumes can cause loss of consciousness and may lead to death.
- Work only when there is sufficient light.
- **DO NOT** use your Lawn Mower when it is raining or when the grass is wet.
- Particular precautions must be taken while mowing on slopes or downing stretches. Mow across the face of slopes, **NEVER** down or up.
- Turn off the engine if you must leave the lawn mower unattended, displace the lawn mower or incline it.
- **NEVER** lift the rear of the mower while starting the engine and **NEVER** place your hands and feet underneath the deck or into the rear discharge chute while the engine is running.
- **NEVER** change in any way the rated speed of the engine.
- **NEVER** lift or carry the mower while the engine is running.
- Disconnect the self-propelled system before starting the engine.

Specific Safety Rules

- Always use the BBT Lawn Mower with the grass catcher (7) or/and the deflector (9) in position.
- Stop the engine before emptying the grass catcher (7) or before you change the cutting height.
- While the engine is running, **NEVER** place your hands or feet under the lawn mower or under the grass ejection area.
- Before mowing, remove all foreign objects from the lawn, which maybe thrown by the machine.
- Keep children, bystanders and domestic animals at a safe distance when the lawnmower is in use.
- **NEVER** lift the mower while starting the engine.

WARNING

DO NOT operate your Lawn Mower whilst under the influence of alcohol, drugs or medication.

GENERAL SAFETY RULES

Spark Plug Safety Rules

- Stop the engine and remove the spark plug cover in these cases:
 - » before carrying out any maintenance or work under the deck or near the grass rear discharge chute.
 - » before any maintenance, repairing or checking operations.
 - » before carrying, lifting or removing the mower.
 - » if you leave the mower unattended or changing the cutting height.
 - » to remove and emptying the grass catcher.
 - » after hitting a foreign object, stop the engine and check thoroughly the mower in order to see there is damage. Take the mower to an authorized service station to do the repairing if necessary.

WARNING

After you have stopped the engine, the blade is still in motion for a few seconds. Wait till blades have come to a complete stop.

- If the mower vibrates in an abnormal way, try to find the reasons why, or take your mower to an authorized service station.
- Check all nuts, bolts and screws are tight to be sure the equipment is in a safe working condition.

Fire and Burn Hazards

- Always store petrol in an approved, tightly sealed container. Store container in a cool, dry place.
- Always fill up the tank with a funnel, always fill up your fuel tank outside. **DO NOT** smoke. **DO NOT** use mobile phone.
- Fill up with petrol and oil before starting the engine. **NEVER** open the cap of
- the fuel tank to add petrol while the engine is running or still hot.
- **DO NOT** start the engine if there is spilt petrol, wipe it off the engine and equipment, and move the mower to another area, wait 5 minutes before starting the engine.
- Close tightly the fuel tank cap.

PARTS LOCATION

1. Upper handle
2. Lower handle
3. Engine control bar
4. Throttle control
5. Engine
6. Chassis
7. Self-propelled function control bar
8. Electrical start key

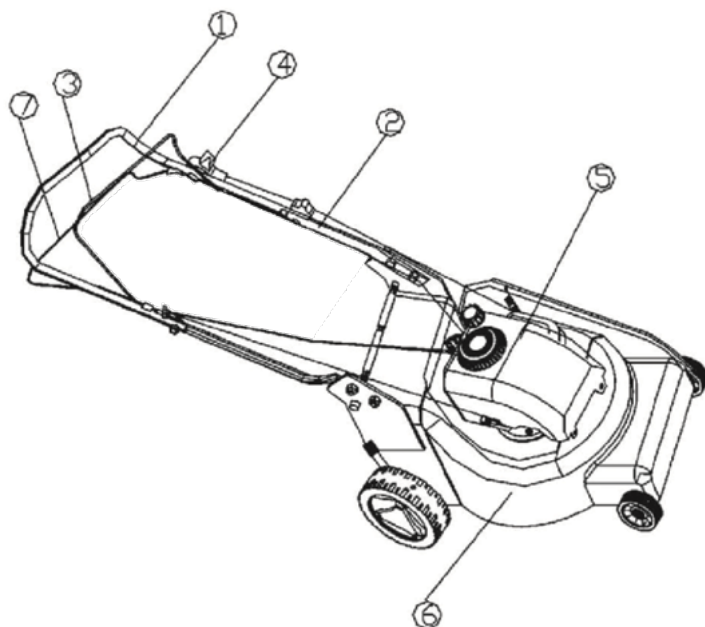

ASSEMBLING

Grass Catcher

- A. Put the metallic frame inside the grass catcher.
- B. Fix the bag on the metallic frame.
- C. Pull up the deflector and place the grass catcher in its place.

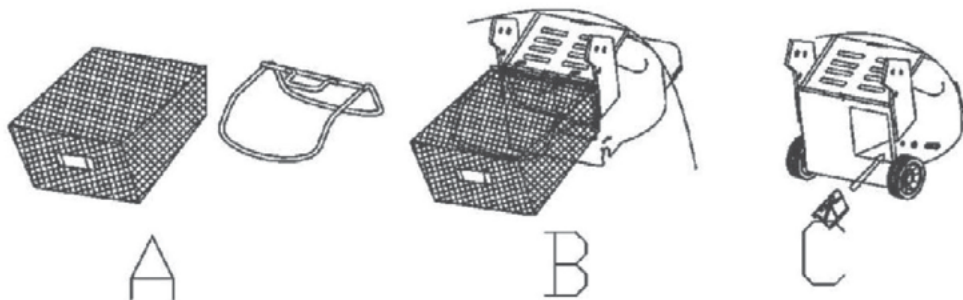

ASSEMBLING

Handle

- Open out the handle and screw the handle parts with the two screws and plastic nuts. Put the recoil starter on the right of the handle and fix the cable with the plastic collar.
- Introduce the rope of the recoil starter handle on its support guide rope.

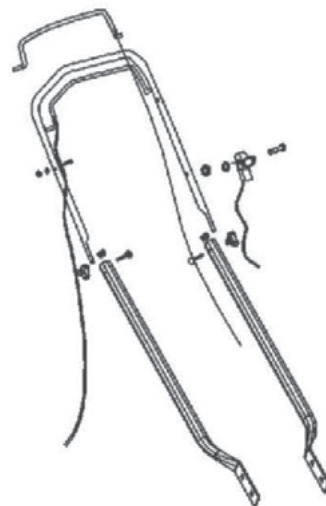

Armrest Panel

Accessories:

- 1x plastic panel in red
- 2x plastic washers in black
- 4x self-tapping screws



Installation steps:

1. First find the support catch and insert the black plastic washers into the support catch with their mounting holes facing outward (as shown in the following figures).
2. Properly position the backing panel so that the back plate screw holes can match the plastic washers for proper mounting.
3. Tighten the screws, end of assembly.



Assembly and Remove the battery

Assembly

1. Press and hold the battery latch buttons at both sides of the battery pack.
2. Make sure latch on bottom of battery pack snaps in place and that battery pack is fully seated.



Remove

1. Press and hold the battery latch buttons at both sides of the battery pack.
2. Remove battery pack from the mower.



ASSEMBLING

Starting Electric Start Engine

1. The unit is equipped with a rubber boot over the end of the spark plug, make certain the metal loop on the end of the spark plug wire (inside the rubber boot) is fastened securely over the metal tip on the spark plug.
2. Standing behind the unit, grasp the brake control handle and hold it against the upper handle as shown in (Fig. F).
3. Turn the ignition key fully to the right in the ignition lock. (Fig. F/G)
4. As soon as the motor starts running, release the ignition key. (Fig. H)



F



G



H

⚠ CAUTION

- Start the engine carefully according to instructions and with feet well away from the blade.
- Do not tilt the lawn mower when starting the engine. Start the mower on a level surface, free of high grass or obstacles.
- Keep hands and feet away from rotating parts. Do not start the engine when standing in front of the discharge opening.

Cutting Height Adjustments

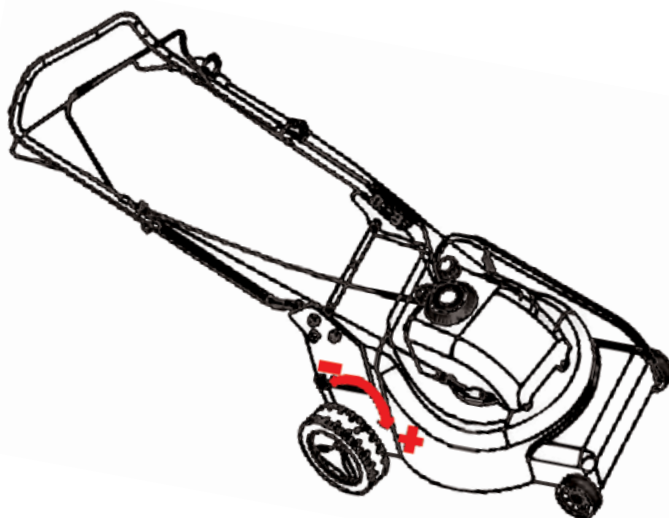

ASSEMBLING

Safety Precautions

- a. Always use the lawn mower with the grass catcher or/ and the deflector in position.
- b. Stop the engine before emptying the grass catcher or before you change the cutting height.
- c. While the engine is running, never place your hands or feet under the lawn mower or under the grass ejection area. (Fig. I)
- d. Before mowing, remove all foreign objects from the lawn, which may be thrown by the machine. (Fig. J)
- e. Keep children, other people and domestic animals at a safe distance when the lawn mower is in use.
- f. **NEVER** lift the mower while starting the engine. (Fig. L)

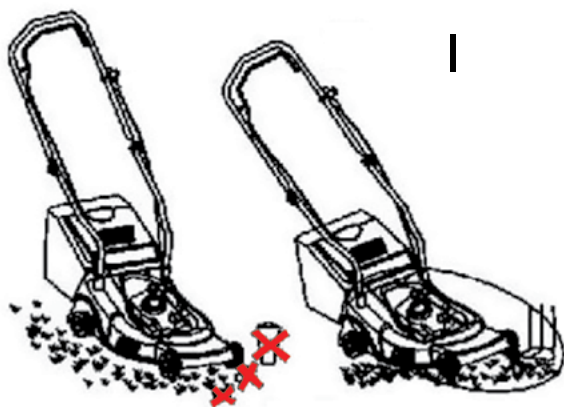

K

OPERATIONS

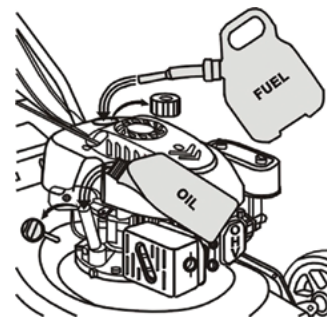

⚠ CAUTION

- All mowers are delivered without oil. Add 0.6 litres of oil before starting the engine.
- Before using the machine you must read the Engine instruction book.



Engine Starting

Once the machine has been set up properly, start the engine as follows:

- Put the lever on the **START** position or 
- Hold lever handle (3) and maintain it against the superior handle, Turn the ignition key fully to the right in the ignition lock. As soon as the motor starts running, release the ignition key.
- Put the lever on **RUN** position or .

Blade is in action as soon as engine is started. While the machine is working, maintain the security handle (3) in working position. The engine will stop as soon as you release the engine control bar.

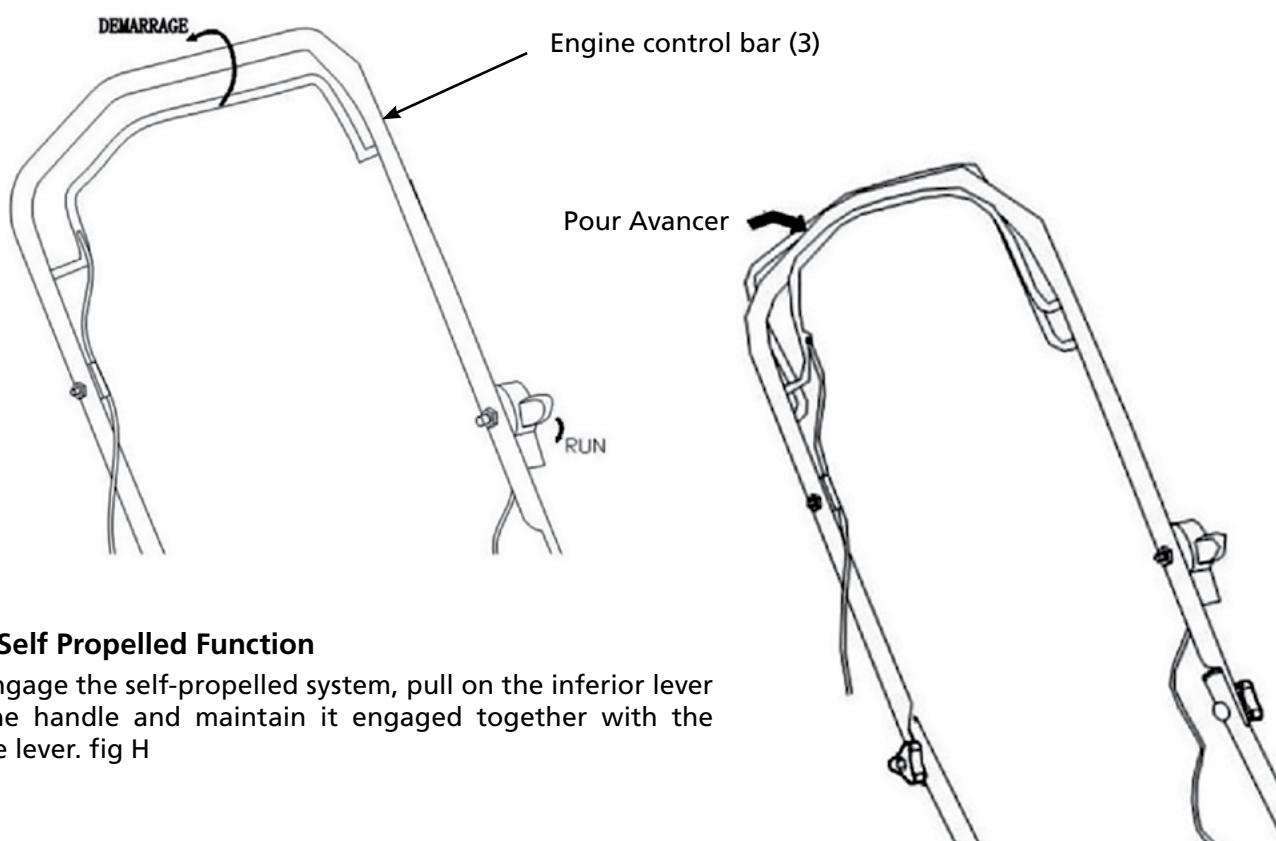

The Self Propelled Function

To engage the self-propelled system, pull on the inferior lever of the handle and maintain it engaged together with the brake lever. fig H

Gear Box

Check frequently the self-propelled system. Polish the gear in the wheels and put grease on them. Do the same check on the ball bearing if any.

OPERATIONS

3 in 1 Function (Mulching, Side-discharge, Rear-discharge)

This Lawn Mower can be retrofitted from its normal function, based on the application purpose from **Lawn Mower with Rear Discharge** to **Mulching Mower** or as **Side-discharge Mower**.

What is mulching?

When mulching, the grass is cut in one working step, then finely chopped and returned to the grass strip as natural fertilizer.

Hints for mulch-mowing:

- Regular cut-back by max. 2 cm from 6 cm to 4 cm grass height.
- Use a sharp cutting knife.
- **DO NOT** mow wet grass.
- Set max. motor speed.
- Only move at walking pace.
- Regularly clean mulching plug, housing inner side and mowing blade.

Starting operation

Note: The number in front of the text (e.g.3) refers to the figures.

Retrofitting for mulching plug

Only when motor and cutter are at standstill!

- Lift the discharge flap and remove the grass catcher chute.
- Push the mulching plug into the discharge channel. Lock the mulching plug with housing—the nose on the bottom side of mulching wedge grip must snap into the opening on the housing. (Picture 1 and 2)
- Lower the discharge flap again.

Resetting for side-discharge mowing

Only when motor and cutter are at standstill!

- Lift the discharge flap and remove the grass catcher.
- Mount the mulching plug. (see Mulch Mowing)
- Lift rear flap for side discharge. (Picture 3 and 4)
- Mount the discharge channel for side discharge on the support pin of the rear flap. (Picture 5)
- Lower the rear flap—the rear flap lies on the Discharge channel. (Picture 6)

Mowing with the grass catcher chute

For mowing with the grass catcher, remove the mulching plug and discharge channel for side discharge and mount the grass catcher.

Removing the mulching wedge:

Only when motor and cutter are at standstill!

- Lift discharge flap and remove the mulching wedge by unlocking on the housing and removing it. (Picture 7)

Removing the discharge channel for side discharge

Only when the Engine has stopped and blade has stopped rotating!

- Lift rear flap and remove discharge channel. The rear flap automatically closes the discharge opening on the housing by means of spring force.
- Regularly clean the rear flap and discharge opening from grass and dirt buildup.

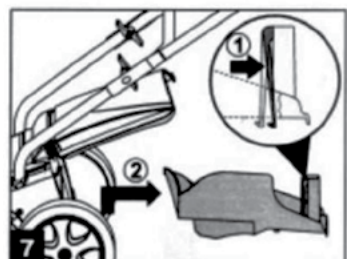
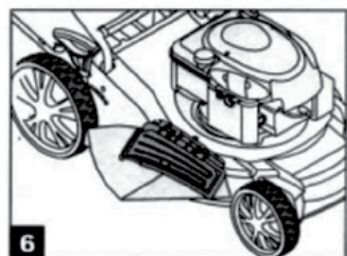
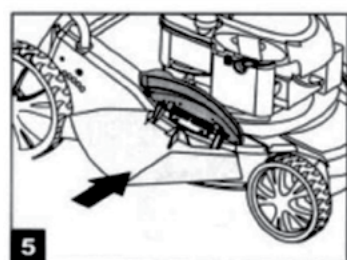
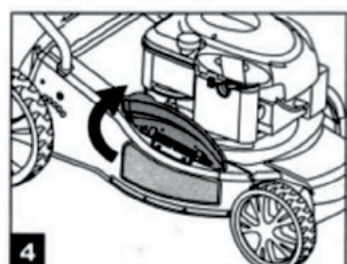
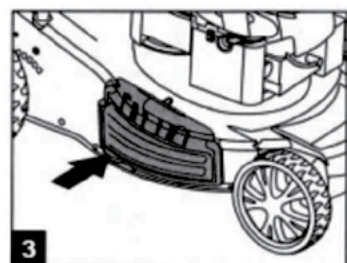
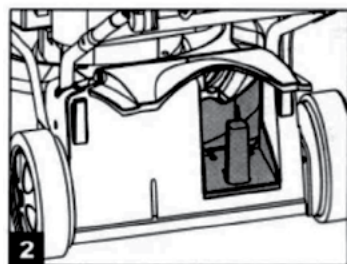
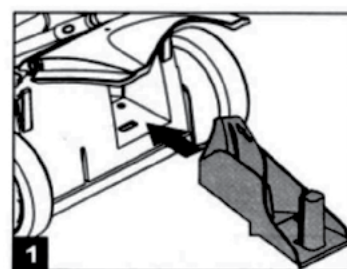

MAINTENANCE CARE

Maintenance and Storage

⚠ WARNING

Stop the engine and unplug the spark plug before any repairing or maintenance work is carried out.

- Make sure that all nuts, bolts and screws are kept well tightened to keep the Lawn Mower in a safe operating condition.
- **NEVER** store the Lawn Mower with petrol in the tank or in an enclosed area where petrol fumes could reach a strong heat source or a flame. Allow the engine to cool down before you store your lawn mower in a storage place.
- In order to reduce any risk of fire, clean the lawn mower in particularly the engine, the muffler, and the fuel tank. Suppress all grass traces, leaves or excess of grease.
- Check frequently the condition of the deflector and the grass catcher, replace them if there is any damage.
- If you have to drain oil from the tank before winter, do this operation outside.
- Wear thick gloves before mounting or sharpening the blade. Be sure that the blade is always well balanced.
- Check regularly the oil level, add oil or replace it if necessary.
- Frequently check the lawn mower and make sure that all grass deposits are removed from beneath the deck.
- Lubricate regularly the wheel axle and the bearing with grease.
- Check blades often, in order to obtain clean work the blade should always be sharp and well balanced.
- At regular intervals check and tighten all bolts and screws. Wear off or badly tightened nuts and bolts can cause damages to the engine or to the frame.
- If the blade hits violently an obstacle, stop the lawn mower and take your mower to an authorized service centre.

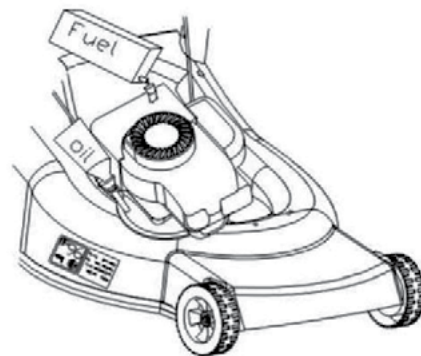

Blade

- The blade is made of pressed steel, in order to obtain a clean work, sharpen the blade frequently, about every 25 hours of work. Be sure that the blade is always well balanced.
- Introduce a small iron axle (2 or 3 mm of diameter) in the central hole of the blade:
- It should stay horizontal. If the blade does not stay horizontal, balance it by taking off some of the metal on the side which is down.
- To remove the blade, unscrew the screw, check the blade support and change all spare parts if they are worn out or damaged.
- To sharpen the blade, place it in a vice and file the cutting edge evenly, checking its balance.
- When reassembling the blade, make sure that the cutting edges face in the direction of the engine's rotation. The blade screw must be torque to
- 3.7Kg*m/s2(37Nm) with a dynamometric tool.

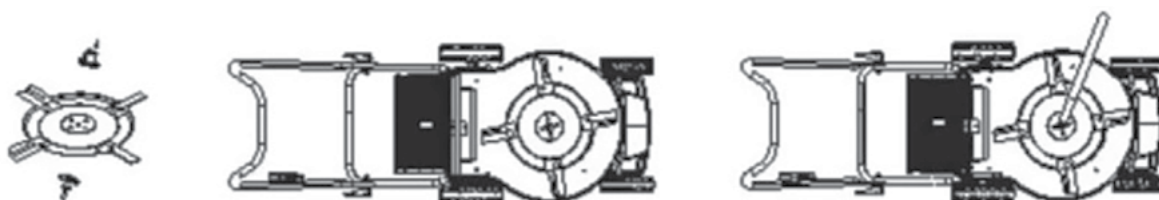

⚠ WARNING

Use only original spare parts. Spare parts of bad quality can cause damages to your lawn mower and compromise your safety.

SPECIFICATIONS

Model	BBT-LM-SPBSES
Rated power	3800 W
Displacement	190 cc
Rated speed	2750 RPM
Max torque	8 Nm
Cutting height range	20 - 55 mm
Number of cutting height adjustments	8
Cutting width	21 inches
Cutting height adjustment	Central height adjust
Wheels diameter (rear-front)	152 - 152 mm
Catcher volume	70 L
Weight	31,5 Kg
Sound pressure	88 dB(A)
Sound power	98 dB(A)
Quantity of strokes of work of the Engine	4
Type of engine cooling	Air cooling
Starting mode	Electric Key Start
Drive system	Self Propelled
Fuel tank capacity	1,5 L
Max permitted slope	20 degrees

Technical Data subject to change without notice.

WARRANTY & SERVICE

Warranties

Bigger Boyz Toyz offer a 1-year parts warranty on all products used for domestic use from the date of purchase. For all commercial use, a 3-month parts warranty period applies, unless specified in the item listing. All conditions below are based upon the product being faulty or not performing as described. In the instance where a return is required, the purchaser is liable for any shipping cost. Warranties will only be determined by a Bigger Boyz Toyz Technician upon inspection.

Warranties do not cover accidents, misuse, neglect, natural disaster or act of God or other external causes, or damage caused by operating the equipment in a manner that is not described in the instructions.

Our products come with guarantees that cannot be excluded under the Australian Consumer Law. You are entitled to a replacement or refund for a major failure and for compensation for any other reasonably foreseeable loss or damage. You are also entitled to have the goods repaired or replaced if the goods fail to be of acceptable quality and the failure does not amount to a major failure.

Parts purchases, consumable components and accessories such as chains, carry bags, batteries, hoses, grinding discs, covers, belts, cable, wheels and blades are not covered by standard warranty.

Spare Parts

Spare parts are available. Please see our website (www.bbta.com.au) or contact us at bbt@bbta.com.au for more details.

EXPLODED DIAGRAM & PARTS LIST

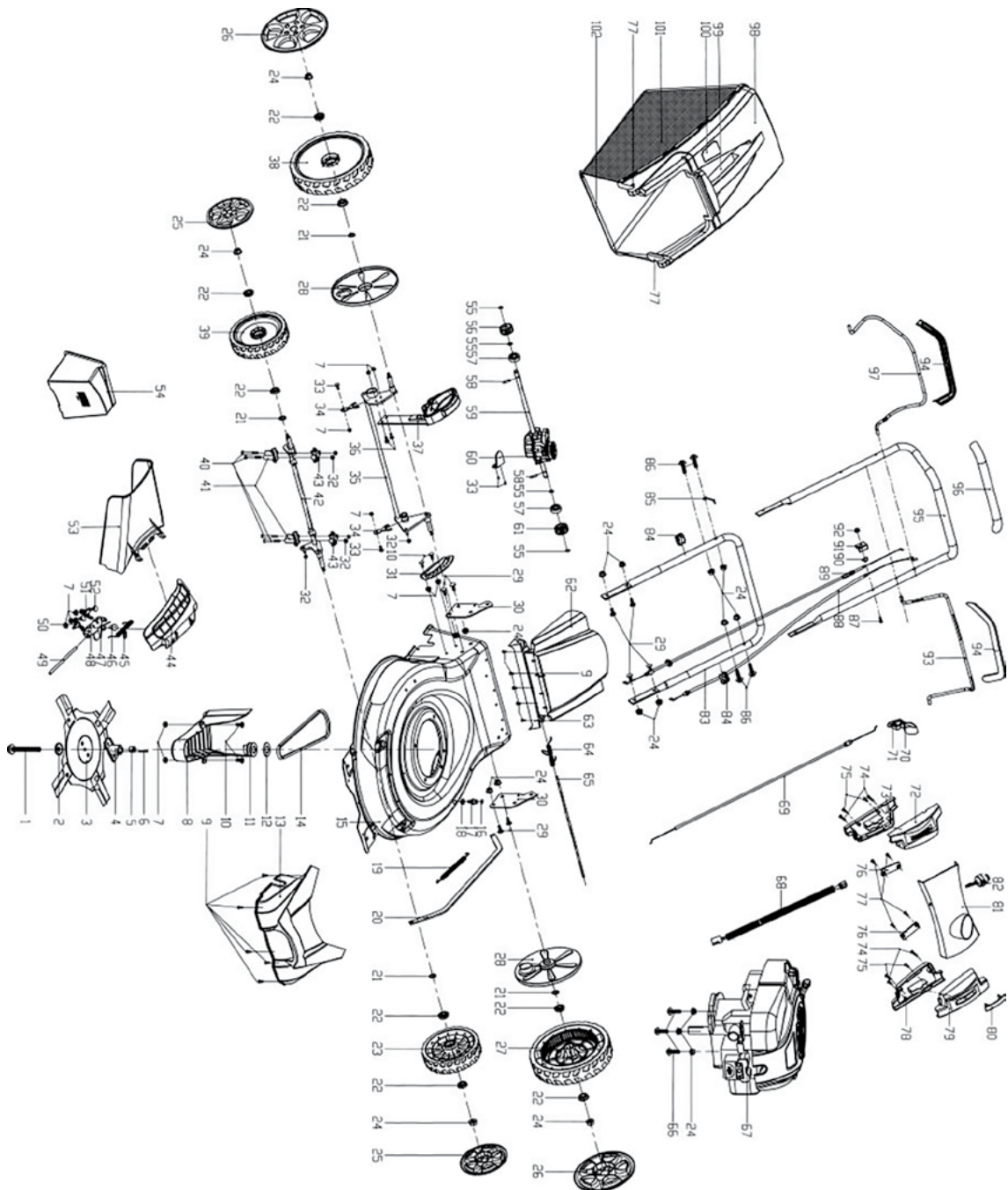

EXPLODED DIAGRAM & PARTS LIST

Drive Unit

NO	SKU	DESCRIPTION	QTY
1	BBT-LM-SPBSES -001	Deck	1
2	BBT-LM-SPBSES -002	Height Adjuster Bar	1
3	BBT-LM-SPBSES -003	Board	1
4	BBT-LM-SPBSES -004	Front Wheel Disc	2
5	BBT-LM-SPBSES -005	Screw M6 x 16	4
6	BBT-LM-SPBSES -006	Washer	4
7	BBT-LM-SPBSES -007	Bearing	8
8	BBT-LM-SPBSES -008	Front Wheel	2
9	BBT-LM-SPBSES -009	Washer 12	4
10	BBT-LM-SPBSES -010	Front Axle	1
11	BBT-LM-SPBSES -011	Uncork Pin	2
12	BBT-LM-SPBSES -012	Front Axle Support	2
13	BBT-LM-SPBSES -013	Nut M6	12
14	BBT-LM-SPBSES -014	Spring	2
15	BBT-LM-SPBSES -015	Press Plate	2
16	BBT-LM-SPBSES -016	Pulley	1
17	BBT-LM-SPBSES -017	Belt Cover	1
18	BBT-LM-SPBSES -018	Screw ST4.8 x 13	2
19	BBT-LM-SPBSES -019	Long Key 4.775*5*34	1
20	BBT-LM-SPBSES -020	Blade Holder	1
21	BBT-LM-SPBSES -021	Cushion	1
22	BBT-LM-SPBSES -022	Blade	1
23	BBT-LM-SPBSES -023	Wing Washer	1
24	BBT-LM-SPBSES -024	Screw	1
25	BBT-LM-SPBSES -025	Air Path	1
26	BBT-LM-SPBSES -026	Deflector	1
27	BBT-LM-SPBSES -027	Rear Wheel Disc	2
28	BBT-LM-SPBSES -028	Rear Wheel	2
29	BBT-LM-SPBSES -029	Axes Circle	2
30	BBT-LM-SPBSES -030	Left Output Gear	1
31	BBT-LM-SPBSES -031	Right Output Gear	1
32	BBT-LM-SPBSES -032	Pin	2
33	BBT-LM-SPBSES -033	Dust-proof Wheel Cover	2
34	BBT-LM-SPBSES -034	Bearing	2
35	BBT-LM-SPBSES -035	Bearing Sheath	2
36	BBT-LM-SPBSES -036	Washer 22.5	2
37	BBT-LM-SPBSES -037	Axes Circle	2
38	BBT-LM-SPBSES -038	Rear Axle	1
39	BBT-LM-SPBSES -039	Height Adjuster	1
40	BBT-LM-SPBSES -040	Screw M6 x 12	4
41	BBT-LM-SPBSES -041	Screw M6 x 55	4
42	BBT-LM-SPBSES -042	Screw MI 025	3
43	BBT-LM-SPBSES -043	Screw ST4.8 x 16	10
44	BBT-LM-SPBSES -044	washer 3 x 20 x 1.5	4
45	BBT-LM-SPBSES -045	Collapsible	2
46	BBT-LM-SPBSES -046	Screw M5 x 12	8
47	BBT-LM-SPBSES -047	Gearbox Cover	1
48	BBT-LM-SPBSES -048	Sealed Washer	1
49	BBT-LM-SPBSES -049	Driving Axes	1
50	BBT-LM-SPBSES -050	Umbellate Gear 39	1

NO	SKU	DESCRIPTION	QTY
51	BBT-LM-SPBSES -051	Washer 13 x 20 x 0.8	1
52	BBT-LM-SPBSES -052	Pin	1
53	BBT-LM-SPBSES -053	Umbellate Pinion	1
54	BBT-LM-SPBSES -054	Spring Washer	1
55	BBT-LM-SPBSES -055	Ball Bearing	1
56	BBT-LM-SPBSES -056	Screw M6 x 16	4
57	BBT-LM-SPBSES -057	Height Dial	1
58	BBT-LM-SPBSES -058	Screw M6 x 16	8
59	BBT-LM-SPBSES -059	Handle Support	2
60	BBT-LM-SPBSES -060	Spring	1
61	BBT-LM-SPBSES -061	Pulley Guider Bar	1
62	BBT-LM-SPBSES -062	Pin 5 x 60	1
63	BBT-LM-SPBSES -063	Follower Pulley	1
64	BBT-LM-SPBSES -064	Gearbox	1
65	BBT-LM-SPBSES -065	Axles	2
66	BBT-LM-SPBSES -066	Axles Bush	1
67	BBT-LM-SPBSES -067	Belt 850Li	1
68	BBT-LM-SPBSES -068	Side Discharge Pole	1
69	BBT-LM-SPBSES -069	Side Discharge Support	1
70	BBT-LM-SPBSES -070	Spring	1
71	BBT-LM-SPBSES -071	Side Discharge Guider	1
72	BBT-LM-SPBSES -072	Side Sealed Sheet	1
73	BBT-LM-SPBSES -073	Plastic Grass Catcher	1
74	BBT-LM-SPBSES -074	Screw M8	8
75	BBT-LM-SPBSES -075	Lower Handle	1
76	BBT-LM-SPBSES -076	Break Cable	1
77	BBT-LM-SPBSES -077	Screw M8 x 46	2
78	BBT-LM-SPBSES -078	Screw with Plastic Nut	2
79	BBT-LM-SPBSES -079	Hook	1
80	BBT-LM-SPBSES -080	Screw M6	2
81	BBT-LM-SPBSES -081	Washer 6 x 12 x 1.5	6
82	BBT-LM-SPBSES -082	Upper Handle	1
83	BBT-LM-SPBSES -083	Screw M6 x 35	2
84	BBT-LM-SPBSES -084	Foam Protector	1
85	BBT-LM-SPBSES -085	Driving Holder Bar	1
86	BBT-LM-SPBSES -086	Break Holder Bar	1
87	BBT-LM-SPBSES -087	Decorative Sheet	1
88	BBT-LM-SPBSES -088	Rear Cover	1
89	BBT-LM-SPBSES -089	Damper Grip	1
90	BBT-LM-SPBSES -090	Single Throttle Control	1
91	BBT-LM-SPBSES -091	Screw ST4.2 x 16	4
92	BBT-LM-SPBSES -092	Driving Cable	1
93	BBT-LM-SPBSES -093	Engine	1
94	BBT-LM-SPBSES -094	Spring	1
95	BBT-LM-SPBSES -095	Rear Cover	1
96	BBT-LM-SPBSES -096	Pole	1
97	BBT-LM-SPBSES -097	Spring	1

YOU MAY ALSO LIKE



Chainsaws



Cultivators / Tillers



Log Splitters



Mulcher

Enquiry or problems with our products?

CALL US (02) 4257 4787



www.bbta.com.au

COPYRIGHT © BIGGER BOYZ TOYZ AUSTRALIA PTY.LTD.
Unit 2/3 Delta Place, Albion Park Rail NSW 2527
BBT-LM-SPBSES-MNL1809